

## Socket Allen Screw

**Head Style:** Button Flange Head

**Drive Type:** Internal Hex

**Thread Type:** Metric - Coarse

**Material:** Stainless Steel

**Class Grade:** A4-70 G316

**Corrosion Protection Level:** Ultimate

**Standard:** ISO 7380-2

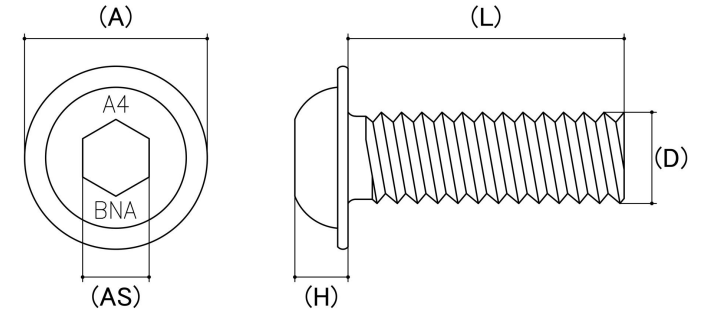

*Cad Drawings shown for graphic representation only.\**

Size	Thread Pitch (mm)	Thread Type	Product Diameter (D) (mm)		Head Diameter (A) (mm)		Head Height (H) (mm)		Driver Bit Size (AS) (mm)	sku (Part Number)
			Min	Max	Min	Max	Min	Max		
M4	0.70mm	Coarse	3.83	3.97	8.82	9.40	2.05	2.30	2	31BFLS4M
M5	0.80mm	Coarse	4.82	5.00	11.10	11.80	2.60	2.85	3	31BFLS5M
M6	1.00mm	Coarse	5.82	6.00	12.90	13.60	3.10	3.40	4	31BFLS6M
M8	1.25mm	Coarse	7.78	8.00	17.10	17.80	4.20	4.50	5	31BFLS8M

**Disclaimer:**

Dimensional data and technical information was obtained from publically available sources and not acquired through standard agencies. It has been completed and compiled for reference purposes only; where discrepancies are found they are subject to change without notice. Bolt & Nut Australia makes no warranties or representations regarding the accuracy and validity of the compiled information and data. Contact the relevant standard authorities for accurate and detailed information.

\* Cad Drawings may not reflect diameter, thread length or overall length.

© Bolt & Nut Australia Pty Ltd. All rights reserved.

Version: 29 Aug 2024